

CONDO DESIGNATIONS

PREVIOUS	CURRENT
4A1 THROUGH 4A8	41.01 THROUGH 41.08
4B1 THROUGH 4B8	42.01 THROUGH 42.08
4C1 THROUGH 4C8	43.01 THROUGH 43.08
4D1 THROUGH 4D8	44.01 THROUGH 44.08
4E1 THROUGH 4E8	45.01 THROUGH 45.08
4F1 THROUGH 4F8	46.01 THROUGH 46.08
4G1 THROUGH 4G8	47.01 THROUGH 47.08
4H1 THROUGH 4H8	48.01 THROUGH 48.08
4I1 THROUGH 4I8	49.01 THROUGH 49.08
4J1 THROUGH 4J8	50.01 THROUGH 50.08
4K1 THROUGH 4K8	51.01 THROUGH 51.08
4L1 THROUGH 4L8	52.01 THROUGH 52.08
4M1 THROUGH 4M8	53.01 THROUGH 53.08
4N1 THROUGH 4N8	54.01 THROUGH 54.08
4O1 THROUGH 4O8	55.01 THROUGH 55.08
4P1 THROUGH 4P8	56.01 THROUGH 56.08
A1 THROUGH A8	1.01 THROUGH 1.08
B1 THROUGH B8	2.01 THROUGH 2.08
C1 THROUGH C8	3.01 THROUGH 3.08
D1 THROUGH D8	4.01 THROUGH 4.08
E1 THROUGH E8	5.01 THROUGH 5.08
F1 THROUGH F8	6.01 THROUGH 6.08
G1 THROUGH G8	7.01 THROUGH 7.08
H1 THROUGH H8	8.01 THROUGH 8.08
I1 THROUGH I8	9.01 THROUGH 9.08
J1 THROUGH J8	10.01 THROUGH 10.08
K1 THROUGH K8	11.01 THROUGH 11.08
L1 THROUGH L8	12.01 THROUGH 12.08
M1 THROUGH M8	13.01 THROUGH 13.08
N1 THROUGH N8	14.01 THROUGH 14.08
O1 THROUGH O8	15.01 THROUGH 15.08
P1 THROUGH P8	16.01 THROUGH 16.08
Q1 THROUGH Q8	17.01 THROUGH 17.08

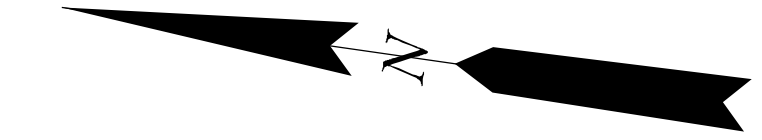

SEE SHEET 5

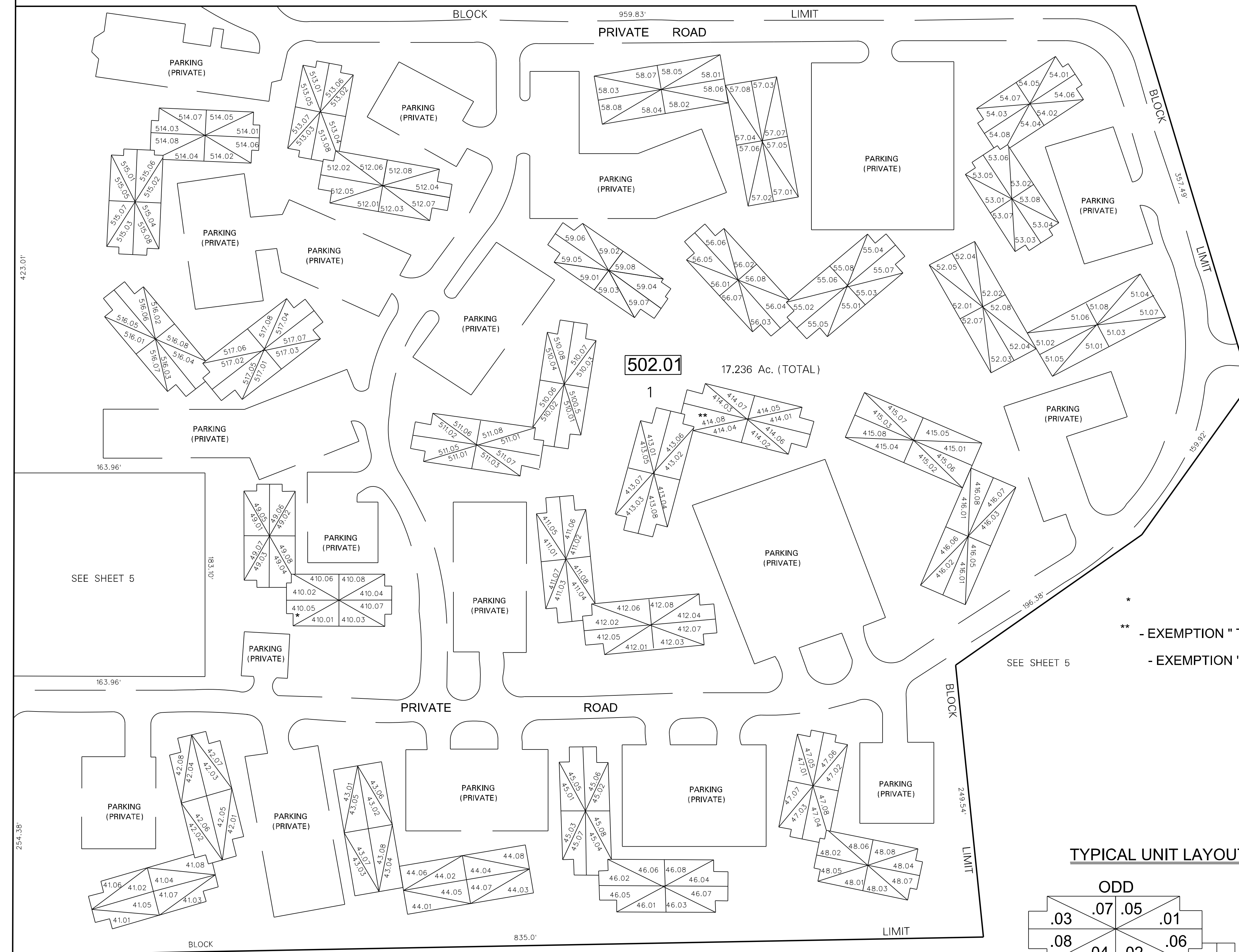

SEE SHEET 5

REVISIONS	DATE

502.01 17.236 Ac. (TOTAL)

* - EXEMPTION " THE SALT & LIGHT COMPANY, INC. (N.P.O.)", UNIT 410.05 (FORMERLY 4J5)
 ** - EXEMPTION " FAMILY SERVICES OF BURLINGTON CO", UNIT 414.08 (FORMERLY 4N8)

TYPICAL UNIT LAYOUT

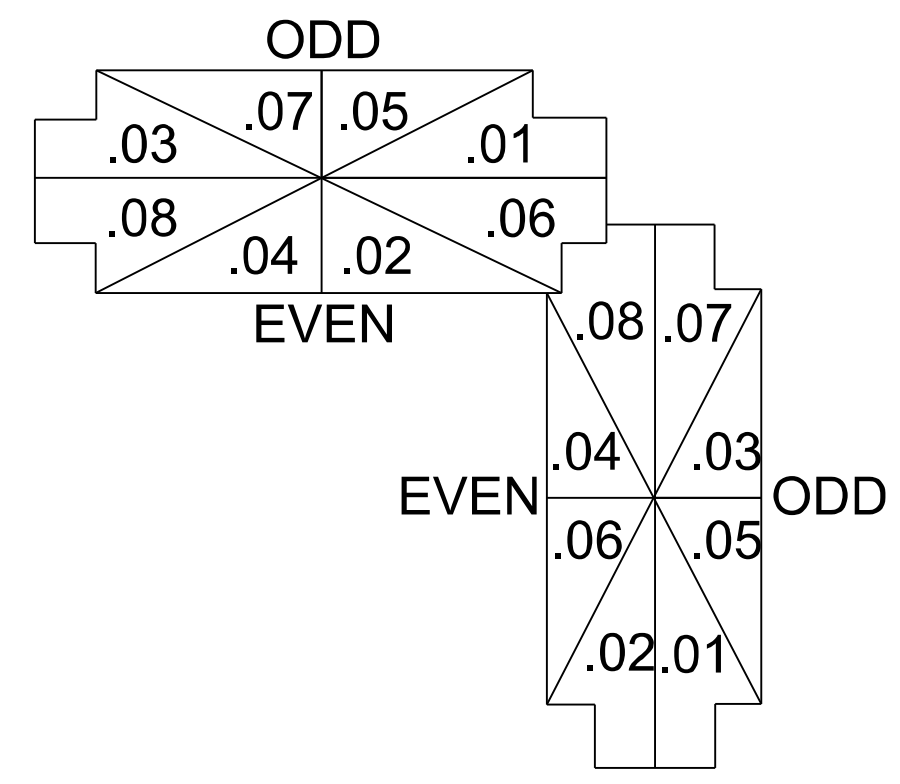

NOTE: UNITS x.01,x.02,x.03, & x.04 ARE LOWER UNITS
 UNITS x.0 ,x.06,x.07, & x.08 ARE UPPER UNITS

"ARBOR GREEN CONDOMINIUMS"
TAX MAP
 EDGEWATER PARK TOWNSHIP
 BURLINGTON COUNTY, NEW JERSEY
 SCALE: 1"=50' DATE: JUNE, 1984
 T. RONALD GSELL, L.S.
 N.J. LICENSE NO. 12812
 200 HIGH STREET, MOUNT HOLLY, N.J.